

RoLED 70/416 RoLED 70/216

System of protection	IP67
Series	Ø 70 mm
Length	725 mm
Protective tube	G = Borosilikat glass K = PMMA
Power LED	35 W
Voltage	24 V/DC or 230 V
Luminous	3600 Lumen
Item nos.	591-155-001 (24 V / 35 W) 591-155-002 (24 V / 35 W) 591-156-001 (230 V / 42 W) 591-156-002 (230 V / 42 W)



CHARACTERISTICS / ADVANTAGE

- LED option to Lumolux KE/236 and KE/436
- machine lamp / tubular lamp
- different versions available
- IP 67



Tested and awarded.
Development and production of TECHMALUX-lamps
conform to European standards.



RoLED 70/416

RoLED 70/216



TYPE	PROTECTIVE TUBE	ITEM NO.	POWER LED	POWER CONSUMPTION	LUMINOUS	LENGTH / MM	VOLTAGE
RoLED 70/416	K	591-155-001	35 W	35 W	3600	725	24 V/DC
RoLED 70/416	G	591-155-002	35 W	35 W	3600	725	24 V/DC
RoLED 70/216	K	591-156-001	35 W	42 W	3600	725	230 V, 50-60 Hz
RoLED 70/216	G	591-156-002	35 W	42 W	3600	725	230 V, 50-60 Hz

Our RoLED-lamp is available in different versions. More information available on request!

DRAWING

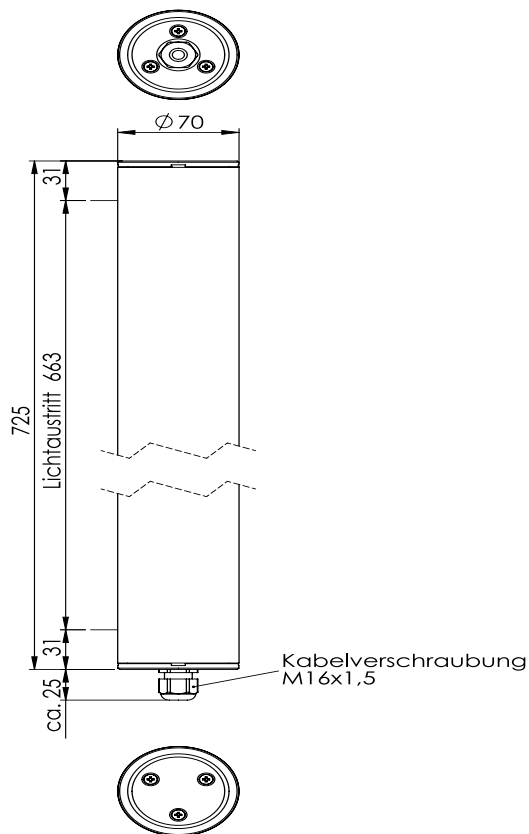

FASTENING with fixing clamp

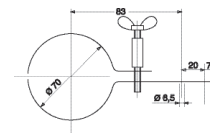

item no. :
599-001-001

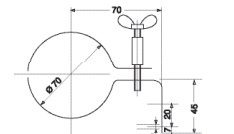

item no. :
599-001-002

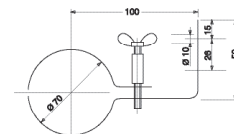

item no. :
599-001-003

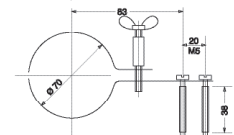

item no. :
599-001-004

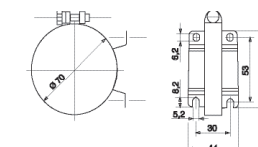

item no. :
599-001-016